

SHEET 60

12/31/12	Tax Map Revisions	DESCRIPTION
	REVISED	
SB	REV. BY	CHK.

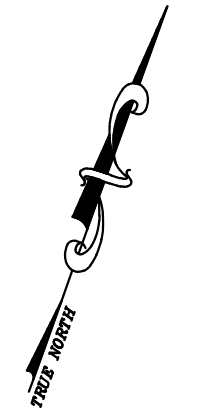

TOWNSHIP OF EDISON - MIDDLESEX COUNTY

NEW JERSEY STATE HIGHWAY ROUTE 4 PARKWAY

SHEET 51

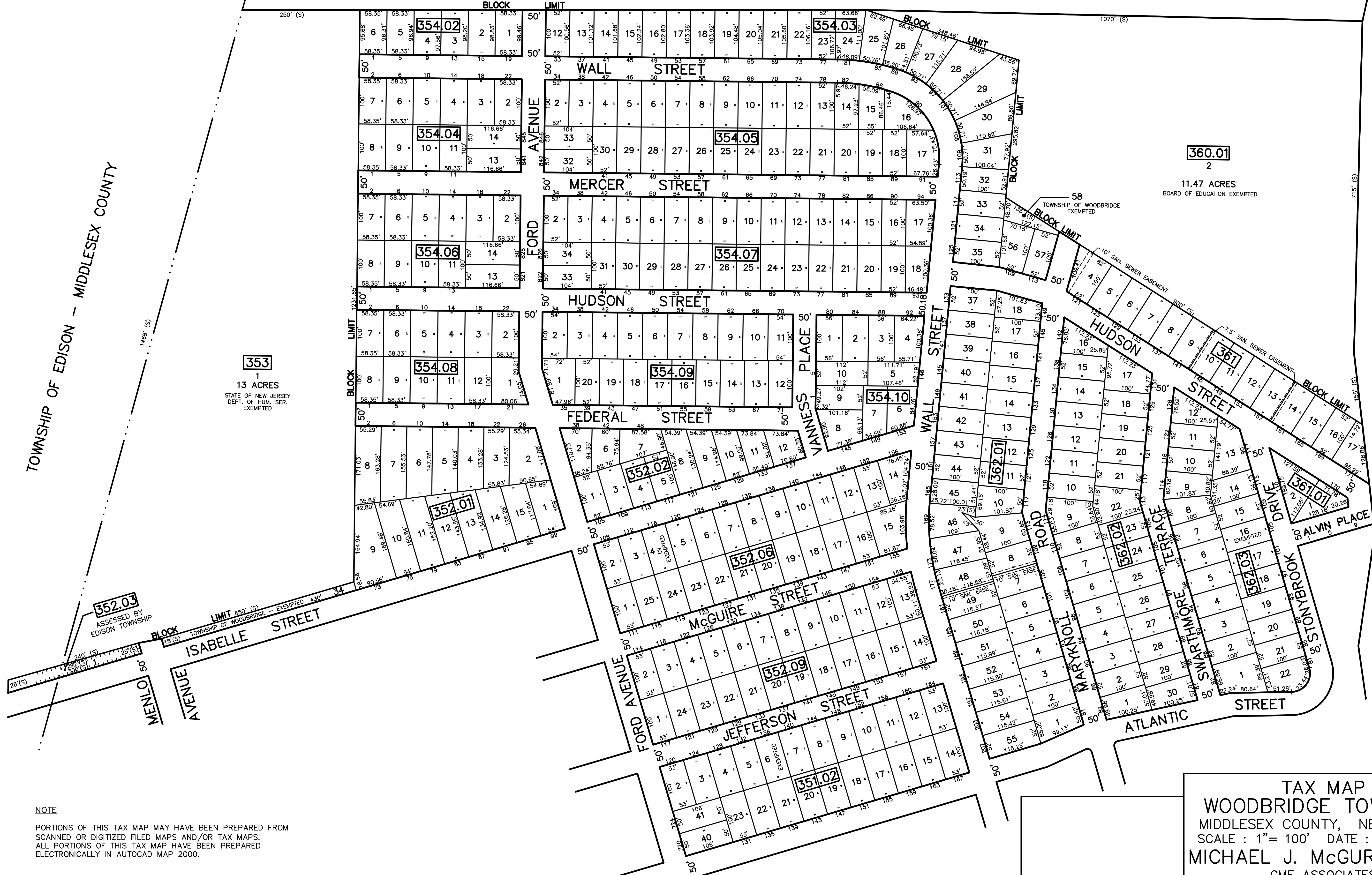

353
1
13 ACRES
STATE OF NEW JERSEY
DEPT. OF HUM. SER.
EXEMPTED

360.01
2
11.47 ACRES
BOARD OF EDUCATION EXEMPTED

NOTE
PORTIONS OF THIS TAX MAP MAY HAVE BEEN PREPARED FROM
SCANNED OR DIGITIZED FILED MAPS AND/OR TAX MAPS.
ALL PORTIONS OF THIS TAX MAP HAVE BEEN PREPARED
ELECTRONICALLY IN AUTOCAD MAP 2000.

TAX MAP
WOODBIDGE TOWNSHIP
MIDDLESEX COUNTY, NEW JERSEY
SCALE : 1" = 100' DATE : JUNE 2008
MICHAEL J. McGURL, P.L.S.
CME ASSOCIATES
3141 BORDENTOWN AVENUE, PARLIN
NEW JERSEY, 08859

SHEET 48

SHEET 49